

Parks and Lands Update

March 18th, 2024



Ryan Baker
Parks Manager

Row & Paddle Club Update



SEE YOU ON THE TRAIL Another Benefit of Hydropower, ChelanPUD.org/Parks

A graphic banner featuring silhouettes of various outdoor activities (jogging, pushing a stroller, roller skating, cycling, sitting on a bench, walking a dog, and walking) against a background of mountains. The Chelan P.U.D. logo is visible on the right side.

P.U.D.
CHELAN COUNTY

Trail Awareness Campaign

- Parks are “here for everyone”
- Speed signage for speed checks
- Engaging local bike rentals
- New rules of the road
- Painting 10 MPH on trail
- Added congestion signage
- Working with security and law enforcement on parking, bike patrols, etc.

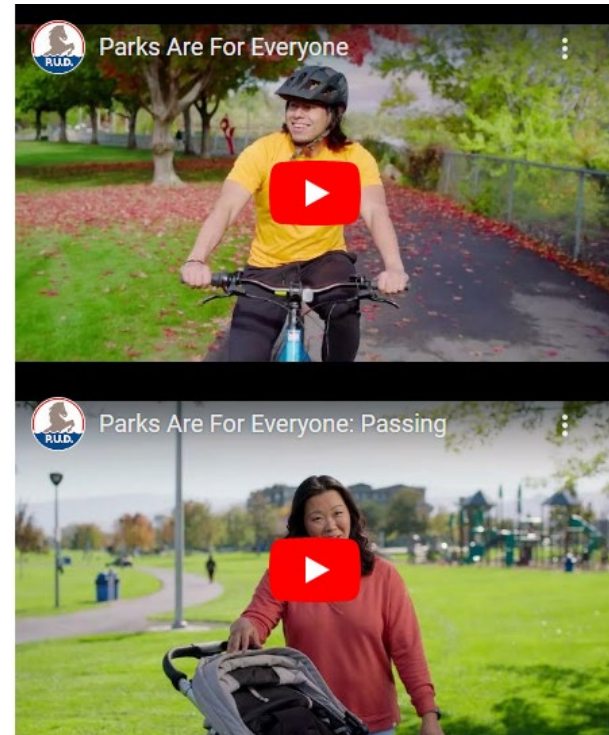

Every day, people are enjoying our parks – biking, jogging, skating, walking pets, playing sports and much more. The PUD wants to provide a high-quality experience, ensure people’s safety and protect these valuable community resources. Chelan PUD parks are here for everyone!

Powerhouse Park Shelter Replacement

Existing shelter



New shelter



Chelan Riverwalk Park Erosion

Riverwalk Park improvements, shoreline restoration

- Temporary Trail Closure
Camino pavimentado temporalmente cerrado
- Work Areas
Áreas de trabajo



Chelan Riverwalk Erosion - Site 1



Wenatchee Riverfront Park Master Plan - Phase 1





Walla Walla Point Park Improvements

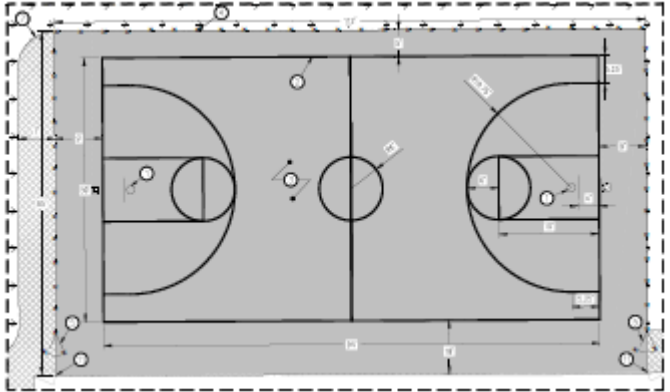
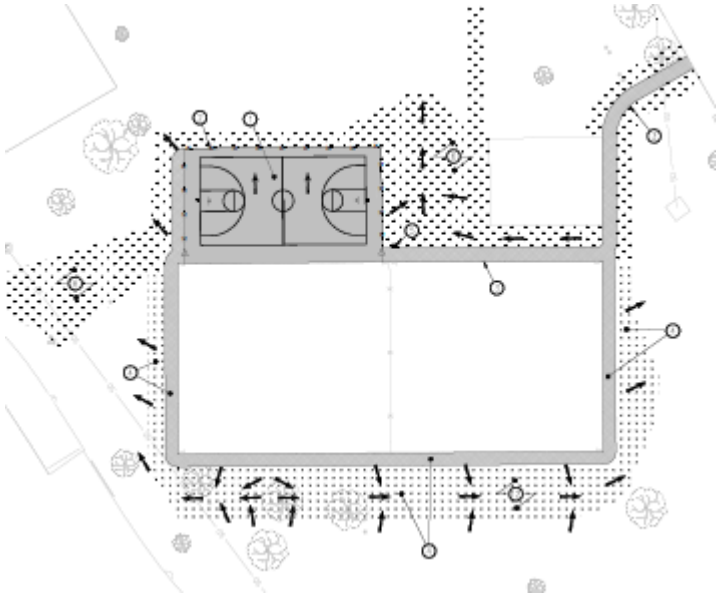

Parks Welcomes Lands Group Back

What does Lands do?

- 50 Substations and switchyards
- 371 Poles, switches, reclosures and platforms fiber and line crews
- 55 Water towers and pump stations
- 25 Technician communication sites
- 10 Fisheries and hatcheries
- Over 200 Fiber and FDT sites
- 13 sites mowing and weed control



Upcoming Projects

- Irrigation evaluation
- Chelan Falls erosion
- Daroga State Park erosion
- Parkwide lighting evaluation
- Ballfield user improvements
- Parking plans



Bleachers at Kirby Billingsley, field 2



Daroga State Park – Erosion

Entiat Agreement Update

- Before



- Proposed



Sport Courts – Seasonal Closure

CLOSED

Seasonal Closure Notice:

Sports courts are closed through early spring. The surface is vulnerable to damage during the freeze/thaw cycle. We will re-open the courts when the weather is reliably above freezing. **Thanks for your patience.**



Summary

- Parks are highly valued by customer-owners and other users
- Proactive approach to address increased park usage and trends
- Significant upgrades to park infrastructure occurring in 2024 and 2025
- Resource protection of our shoreline & assets remain a top priority
- Collaboration with our operating and municipal partners

Questions?

