



PUBLIC UTILITY DISTRICT NO. 1 of CHELAN COUNTY

P.O. Box 1231, Wenatchee, WA 98807-1231 • 327 N. Wenatchee Ave., Wenatchee, WA 98801

(509) 663-8121 • Toll free 1-888-663-8121 • www.chelanpud.org

November 8, 2010

Honorable Kimberly D. Bose, Secretary, and
Nathaniel J. Davis, Sr., Deputy Secretary
FEDERAL ENERGY REGULATORY COMMISSION
888 First Street, NE
Washington, DC 20426

Re: **Lake Chelan Hydroelectric Project No. 637**
Article 407, Settlement Agreement Article 11(k)
Reach 1 Trail Extension As-built

Dear Secretary Bose and Deputy Secretary Davis:

In accordance with Article 301, *Revised Exhibits and As-built Drawings*, the Public Utility District No. 1 of Chelan, County, Washington (Chelan PUD) hereby files an original and five copies of the as-built drawing in electronic format for the Reach 1 Trail extension (formerly known as the Riverwalk Loop Trail Extension). Additionally, one copy will be submitted to the Federal Energy Regulatory Commission's (Commission) Division of Dam Safety and Inspections Portland Regional Engineer and one to the Director, Division of Hydropower Administration and Compliance by copy of this letter.

The Reach 1 Trail extension connects the existing Chelan Riverwalk Loop trail to the newly constructed Reach 1 Trail of the Chelan River. An as-built drawing for the completed Reach 1 Trail was filed with the Commission on March 2, 2009. Construction of the Reach 1 Trail extension started in 2009 and was completed in spring 2010. The trail extension has been added to the Reach 1 Trail as-built drawing. Therefore, please replace the as-built drawing sent previously with the attached updated as-built drawing of the Reach 1 Trail.

Pending your approval, please provide us with an assigned drawing number so that we may submit the aperture cards, electronic files, and location data points needed for the Commission's databases. This work did not affect the Exhibit G Project Boundary.

Please do not hesitate to contact me or Kris Pomianek at (509) 661-4186 of my office regarding any questions or comments.

Sincerely,

Michelle Smith
Licensing and Compliance Manager
michelle.smith@chelanpud.org
(509)661-4180

Enclosure: Original and five copies of the As-built Drawing (.tiff on compact disk)

cc: Mr. Patrick Regan, Division of Dam Safety and Inspections Portland Regional Engineer, one copy of as-built (.tiff on compact disk)
Director, Division of Hydropower Administration and Compliance, one copy of as-built (.tiff on compact disk)

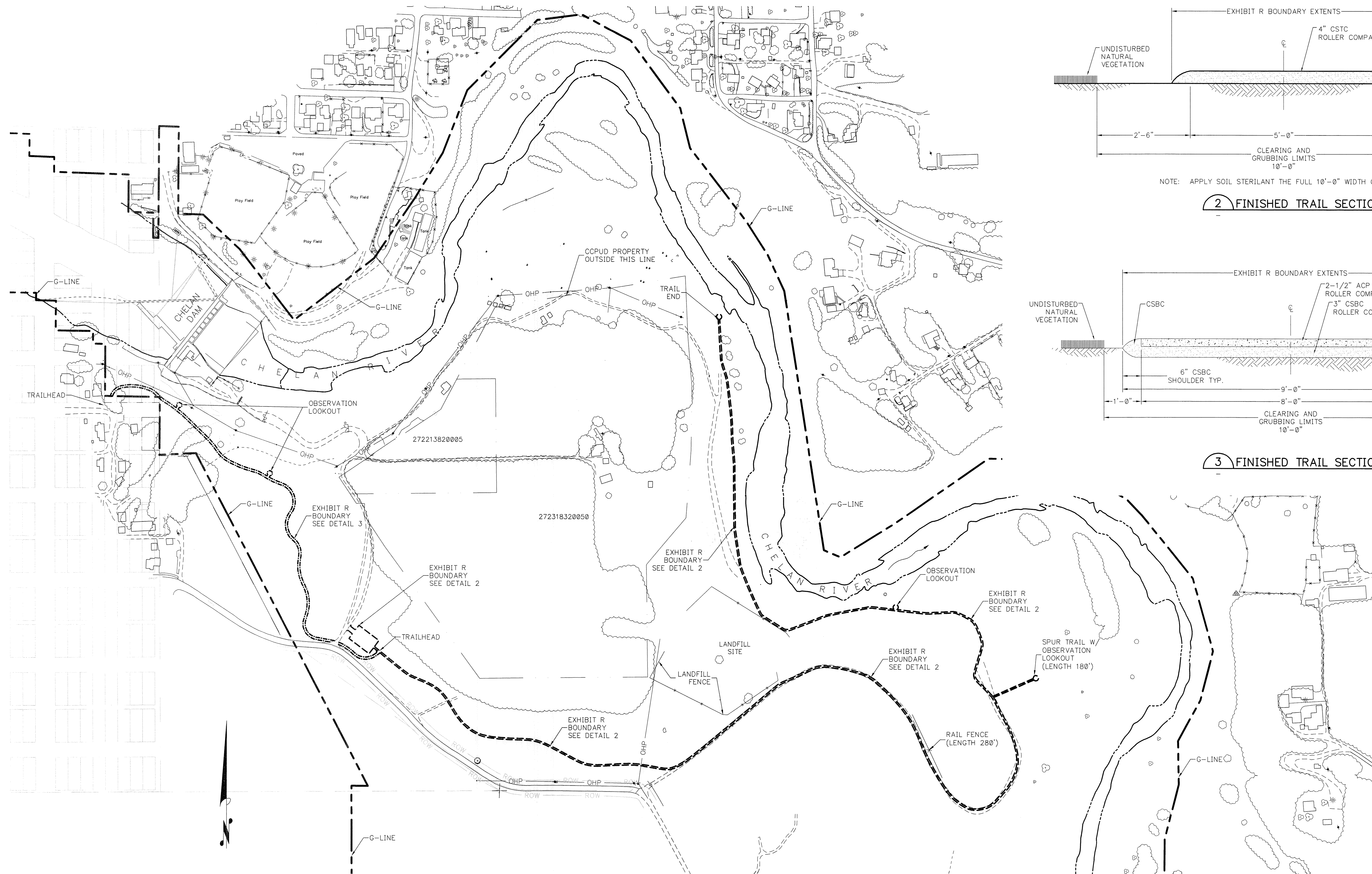

1 TRAIL LAYOUT PLAN
1"=200'

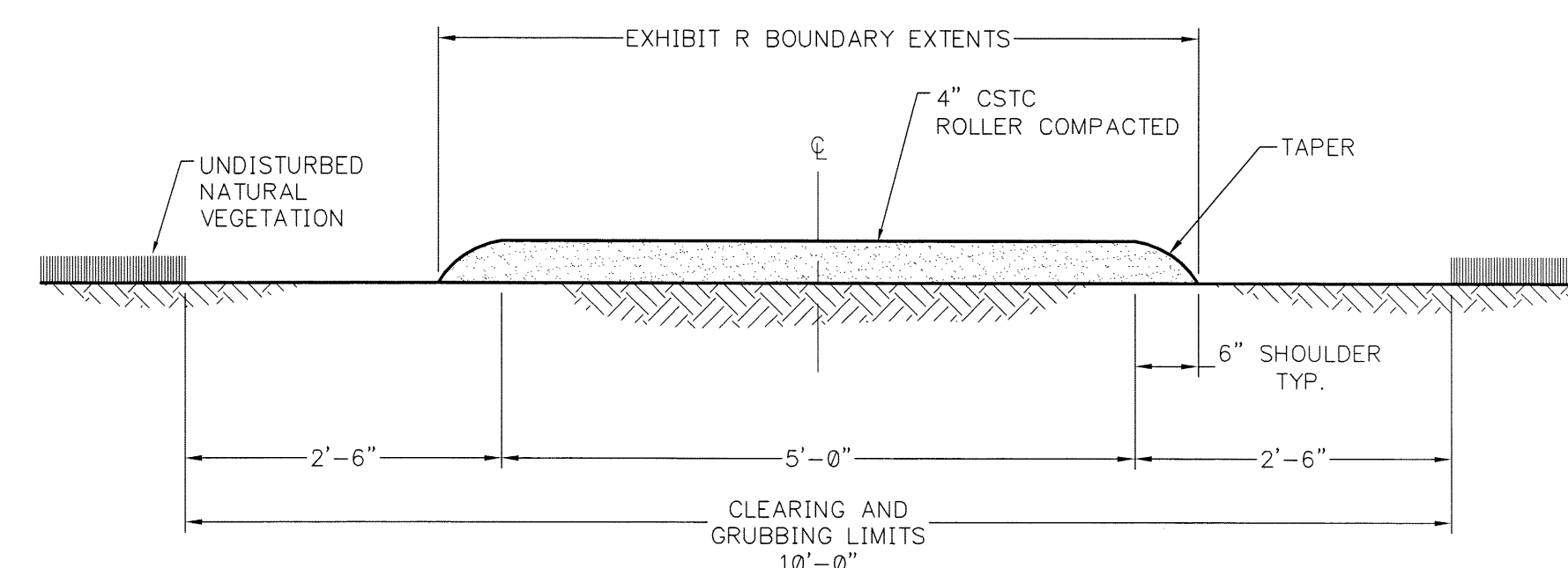

NOTE: APPLY SOIL STERILANT THE FULL 10'-0" WIDTH OF TRAIL SECTION.

2 FINISHED TRAIL SECTION (TYP)
3/4"=1'-0"

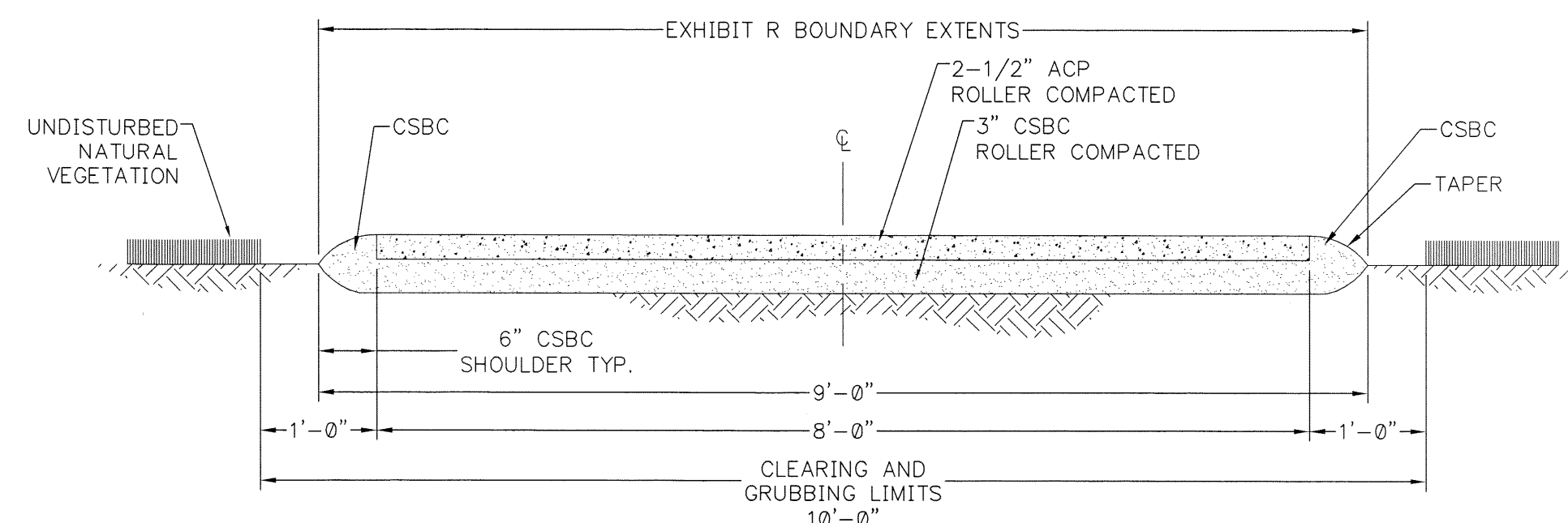

3 FINISHED TRAIL SECTION (TYP)
3/4"=1'-0"

- EXHIBIT R BOUNDARY 2010 ADDITION
- EXHIBIT R BOUNDARY AS OF 2008
- EXHIBIT G BOUNDARY

CHELAN PUD NO.1		SCALE SEE DWG		BAR IS ONE INCH ON ORIGINAL DRAWING.		VERIFY SCALE 0 1"		IF NOT ONE INCH ON THIS SHEET, ADJUST SCALES ACCORDINGLY.		PUBLIC UTILITY DISTRICT NO. 1 OF CHELAN COUNTY WENATCHEE, WASHINGTON		Chelan Riverwalk Park REACH 1 TRAIL EXHIBIT R LAKE CHELAN PROJECT NO. 637-		SHEET 1 OF 1	
PRIM. ENG.		1	11/3/2010							RJS	TPD			REVISION 1	
2ND ENG.										REQ. BY	DRFT			DATE 11/3/2010	
PROJ. MGR.		REV	DATE											DWG. 0901-50YP-0005	

DOCUMENT CLASS:

ID:

ORIGINAL DWG. #: 637-

ORIG. DATE 2/20/2009
ORIG. DRAWN MFS