

Olds Station

PUD Substation Needs and Stemilt Expansion

7/24/17

No action requested at this time
Resolution for approval at future board meeting



CHELAN COUNTY

www.chelanpud.org

Agenda

- Overview of Olds Station capacity planning
- District's plan meets a Stemilt opportunity
- Capacity in lieu of fee (energy is in addition)
- Next steps
- Questions and comments



Key Benefits

- Provides for needed substation capacity in County's industrial area
- Sites substation at load center
- Provides District with space for mobile substation
- Provides space for "double banking"
- Reduced siting and permitting efforts by District staff
- Replaces planned existing equipment at Olds Station



Olds Station Substation



- Replaced components
- Oil filtering
- Inadequate mobile space



Ohme Station Site

- North end of site
- Provide capacity to area
- Provide redundancy option



Capacity in Lieu of Fee

- Stemilt providing to District
 - Approximately 1 acre
 - Site and access grading
 - Underground duct bank installation for future station
 - Access and utility easements
- District providing to Stemilt
 - Use of up to 5MVA of substation capacity
 - Capacity not used by Stemilt District can use



Site Plan

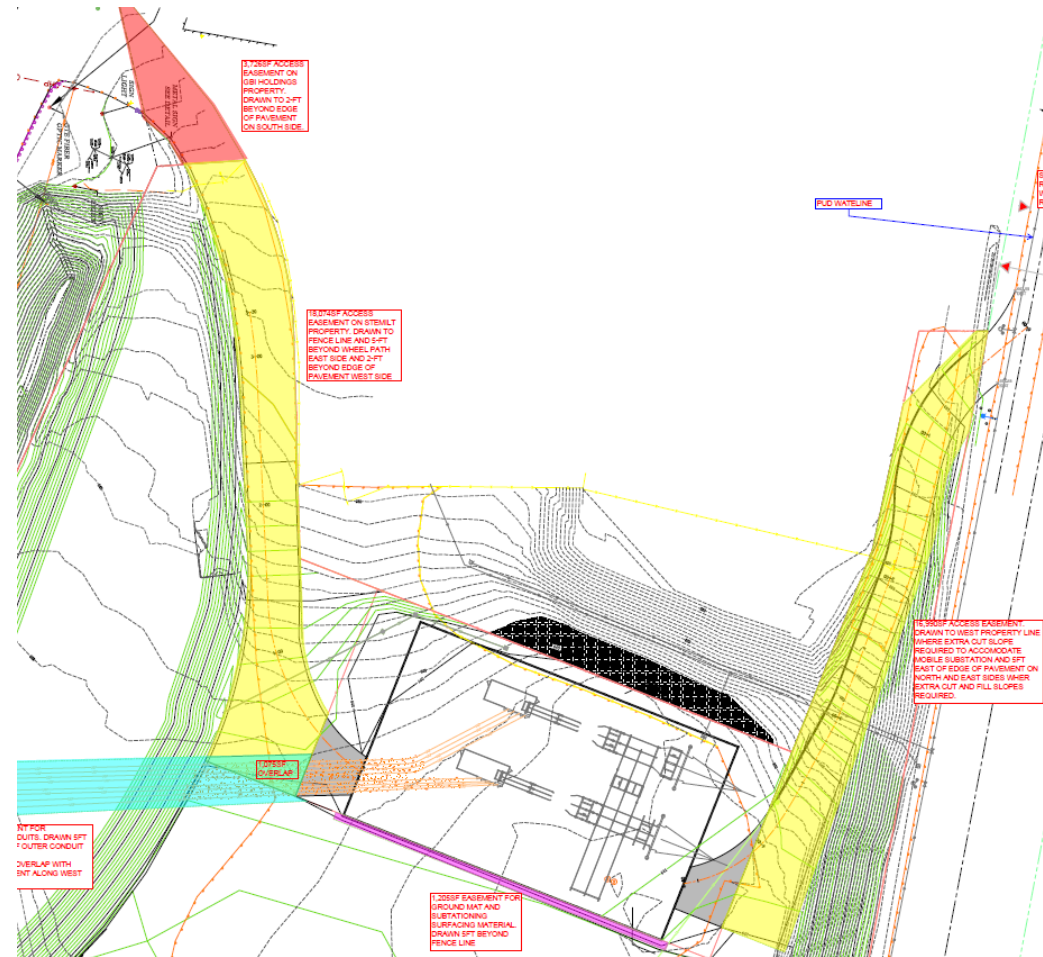

Next Steps

- Finalize capacity and property agreements
- Tentative August 7 Board resolution
- Conditional use permit application this fall
- Railroad permit application this fall
- Begin equipment specification and design this fall
- Construction planned 2018 through 2019

